

**Times for traffic signals.**

All times are in seconds

Phase	①	②	3	4
Location of head	Shire way Inbound	Shire way Outbound	Not in use	Not in use
Red	10	10	0	0
Red/amber	2	2	0	0
Green	25	25	0	0
Amber	3	3	0	0
Phase total	40	40	0	0
Total for cycle				125

Times shown below provide a starting point and should be adjusted to suit prevailing traffic conditions following installation

**Diverted Traffic**

To be positioned in advance of Scott Way / Heron way RBT

**KEY**

- Lane closure area
- works area
- 1m Traffic cone
- Temp traffic signal head (with facing)
- Diversion route
- Temp traffic sign (with facing)

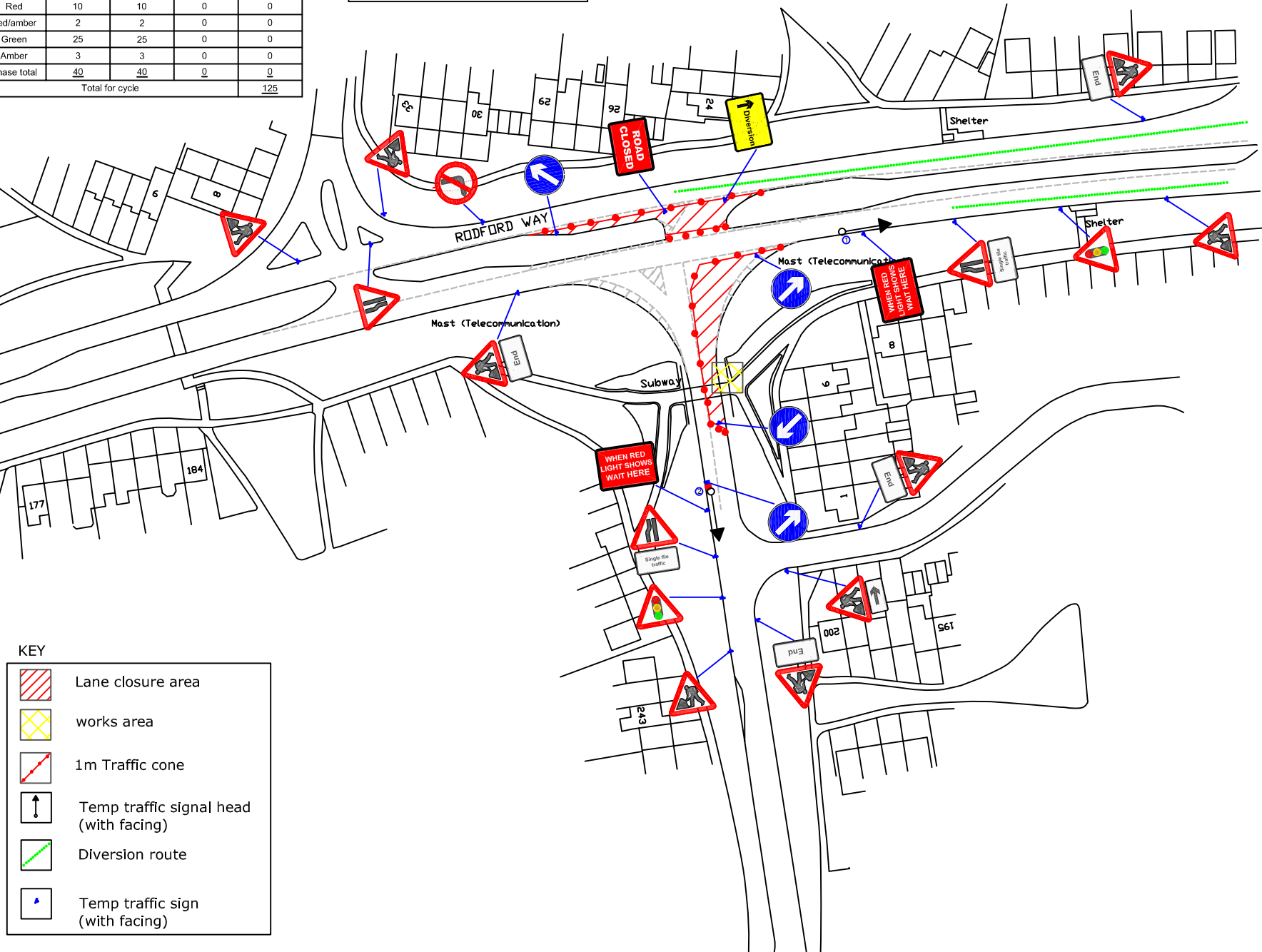

**Coning Detail**

**DETAIL B**

1.5m (3m relaxation)

Traffic cones (45° tapers have 1.2m spacing, no relaxations)

N.B. During darkness, warning lights to BS EN 12352:2006 should be provided in accordance with table A1.3 (Appendix 1)

On motorways and all purpose dual carriageways with hard shoulders on which national speed limit applies, 1m cones will be required for both standard works and works for which relaxations may be applied, for both lead in tapers and the facing wall on a lane change.

**DETAIL C1**

9m

750mm or 1m high traffic cones

N.B. During darkness, warning lights to BS EN 12352:2006 should be provided in accordance with table A1.3 (Appendix 1)

For relaxation to Detail C1 see table A1.3 (Appendix 1)

Rev	Dm	Chk	App	Description	Date